

**SITE PLAN AT MOUZA- UTTAR KAJIRAHAT ; J.L. 22, L.R. DAG NO-112(P),115(P),116(P),117(P) P.S.- BISHNUPUR, UNDER PASCHIM BISHNUPUR GRAM PANCHAYAT, DIST- SOUTH 24 PARGANAS, WEST BENGAL
LAND AREA = 2 BIGHA 15KATHA 12 CHATAK 40 SQ.FT. = 0.92 ACRE = 3732.79 SQ.M. = 40180 SQ.FT**

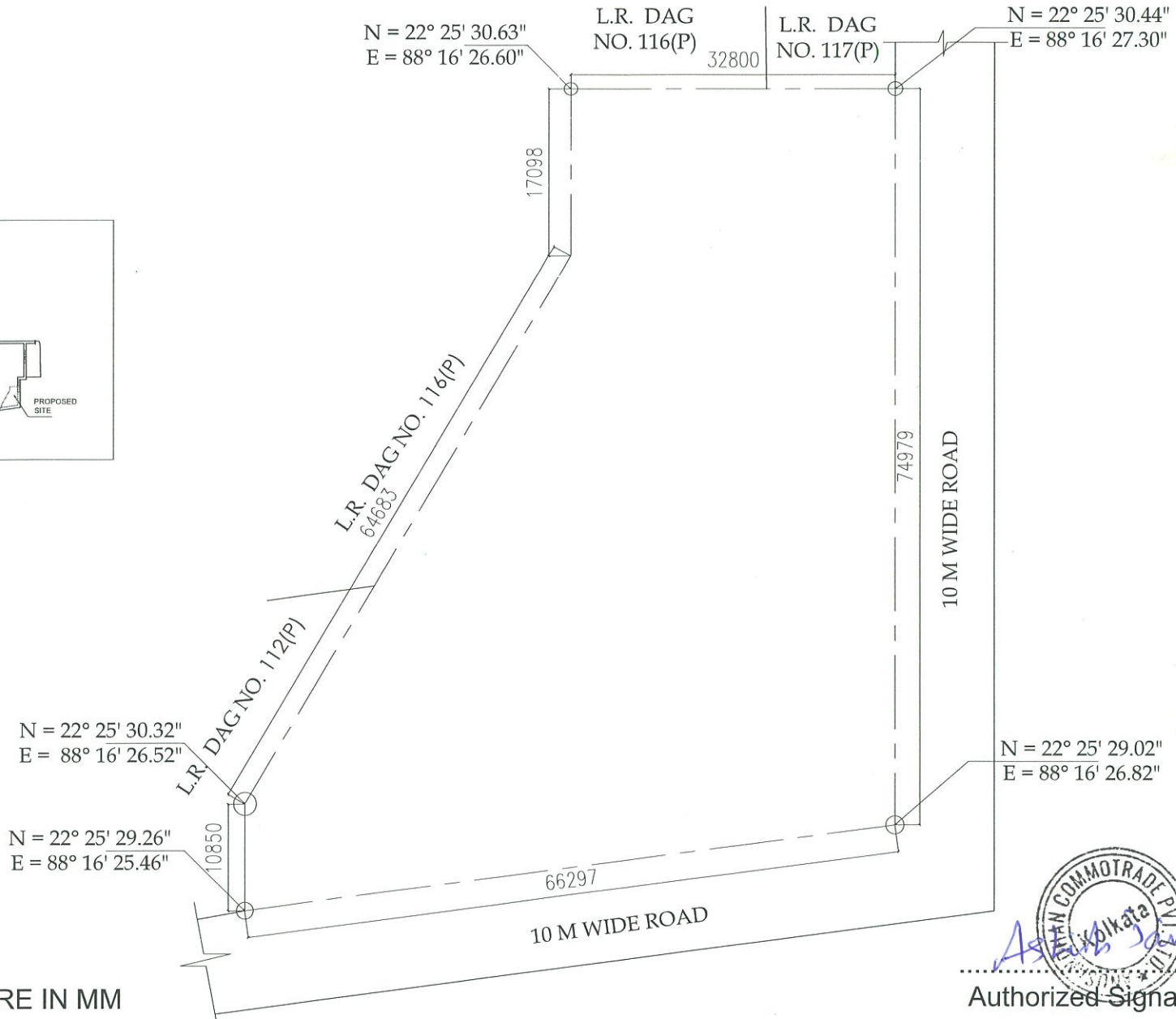
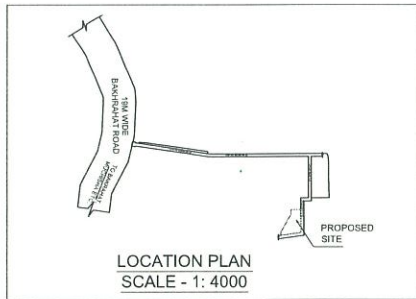

ALL DIMENSIONS ARE IN MM

Authorized Signatory

CIN : U51109WB1995PTC074099

ANUSANDHAN COMMOTRADE (P) LIMITED